



Type V10L-01ZP+01ZP-...

The multi-axis controller V 10 is a rugged switching device according IEC/EN 60947-5-1 for remote control and electro-hydraulic applications. The V 10 is resistant to oil, maritime climate, ozone and UV radiation.

Contact complement 0,5 A 110 V AC 15 or 1,5 A 24 V DC 13
I min > 0,2 mA 2 V DC 12 Gold plated for max. load of 0,12 Watt (standard)

Mechanical life 8 million (operating cycles)
Permissible ambient temperature Operation -40° C to +60° C
Storage -50° C to +80° C

Climate resistance
Damp heat constant IEC 60068-2-78
Damp heat cyclic IEC 60068-2-30
Degree of protection front IP 54 IEC/EN 60529

Technical data see catalog 4/100
Description data see catalog 4/020

Spindle block with schematic representation of the master controller installation and deflection directions. Version shown for left-hand side installation (right-hand side installation is mirror image).

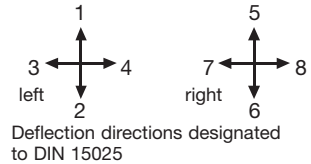

Pos.	V 10.1	V 10	Type expansion		Weight gramm	Type	Price EURO
1					200	V 10.1	
2							
3					250	V 10	
4							
5							
7.1	Multi-axis controller left	(dir. 1-2, 3-4)				L	
7.2	Multi-axis controller right	(dir. 5-6, 7-8)				R	
10	Gate cross-shaped	(prohibits diagonal shifting)			20	P	
11	Gate special-shaped	(e.g. H-gate)			20	PX	
20	Control-handle with knob solid						
21	Control-handle with latch for mechanical zero interlock by lifting				50	M	
22	Control-handle with dead man's button 1 NO				80	T	
23							
24							
25							
26	Control-handle with palm grip B 5				40	B 5	
27	Control-handle with palm grip B 5 with push button top 1 NO				60	B 5D	
28							
29	More knobs, grips and T-grips with and without signal devices see catalog 1/270ff						
30	Masterswitch (contact) without switching sequence			No. of contacts 2	20	01	
31				4	40	02	
32	Direction 1-2 and 3-4 each 1 masterswitch			6	60	03	
33	Switching program according contact-arrangement MS... see catalog 4/001 or to your contact-arrangement		A...				
34							
35							
36	Switching sequence 4-0-4						
38	Spring return in 0-position	(included in the spindle block)				Z	
39	Friction brake adjustable	(for each direction)				R	
40	Potentiometer e.t.c. each direction with mounted Conductive-plastic potentiometer T 320, with centre tap linear 0,5 Watt wiper current max. 1 mA resistance 2 x 1k \cong P252, 2 x 5k \cong P254		...P25 \square		20	P	
41							
42							
43	more Potentiometer e.t.c. see catalog 1/240ff		P...				
44							
45	Electronic (Amplifier, Profi-Bus, CAN-Bus) see catalog 3/510ff		E...				
50	Plastic housing I 122 x 120				350	I	
51							
52	More housing see catalog 1/350						
60	Indicating labels not engraved with 2 or 4 arrows						
61	Engraving, each 10 characters						
70	Command and indicating devices see catalog 1/360						



Knob solid

T = dead man's button

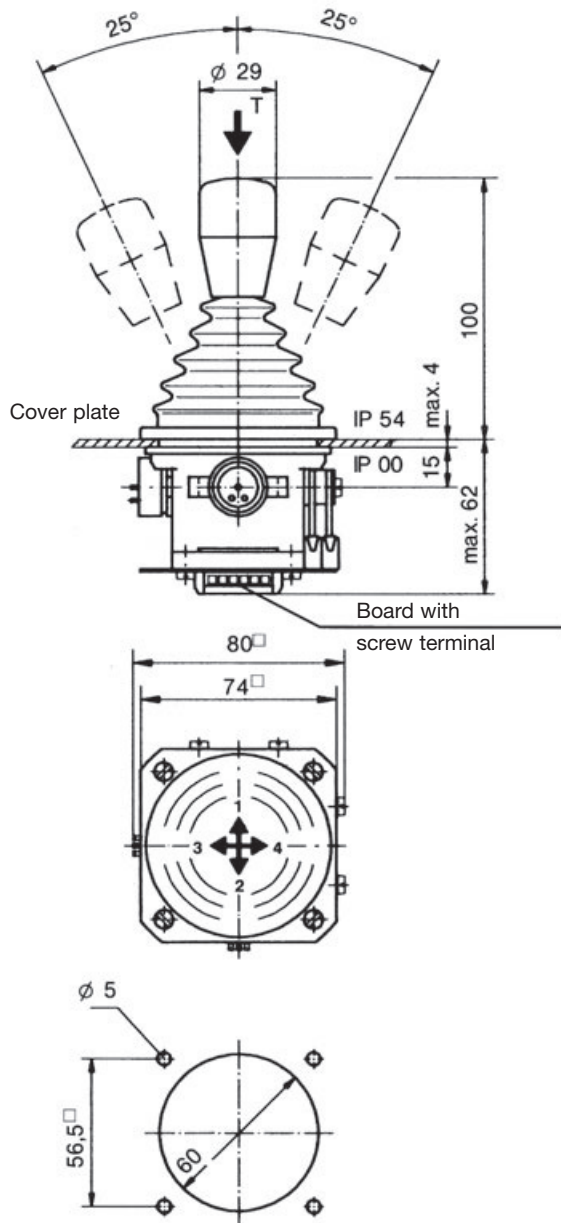

Hole pattern

Ball grip

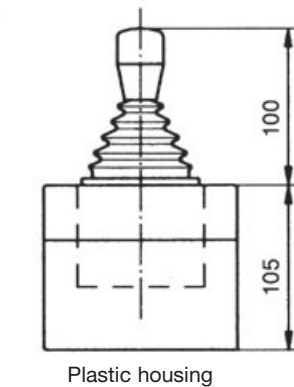
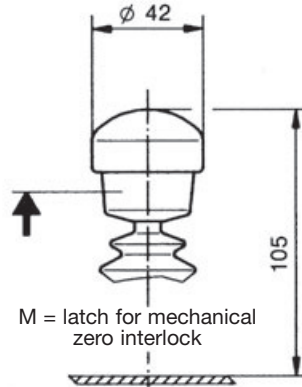

Plastic housing

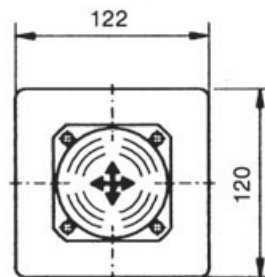

Palm grip B 5

